



# Meet 5

USB PTZ Camera for Huddle Room

## To Make Collaboration Easy and Affordable

Meet 5 is ideal used for video conferencing in the huddle room and small meeting space. It is equipped with Panasonic's advanced sensor, 5x optical zoom lens, 85-degree super wide angle, to output crystal clear image with realistic color, even in low light or high contrast of brightness and darkness environment.

It works with any of your favorite conferencing software, totally plug and play, use-friendly.



**5X**

**85°FOV**

**USB3.0**

**1080P60**

**USB POWER**

### Feature and Benefits:

#### High-definition image

With Panasonic 5MP sensor, to deliver sharp and high-definition image with realistic color; Support WDR, backlight compensation, noise reduction, to adjust image for different working environment.

#### Plug and play

USB3.0 video output 1080p60 resolution, plug and play, work with any of your favorite video conferencing software.

#### Power by USB3.0 port directly

3 cables in 1 design: video, control & power can be transited via single USB3.0 cable.

#### 5x optical zoom, 85-degree FOV

Uses truly 5x optical zoom lens, with super wide angle 85-degree wide angle FOV, to capture details in the meeting room.

#### Easy operation

Matched with IR remote controller, to control PTZ movement, 10 presets and adjust functions as preference in the OSD menu.

#### Smooth and quite PTZ movement

Smart, compact and decent mechanism, to bring smooth, silent and accurate PTZ movement, to make sure everyone is participated in the meeting.

### Compatible With



## Used For

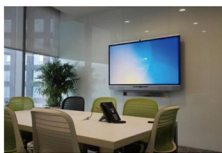
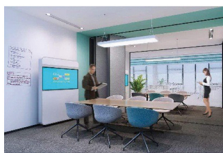

## Product SPEC

Camera		Meet 5	
<b>Item Number</b>	<b>TLC-1000-U3-5</b>		
Sensor	1/2.8-inch high-quality 5MP HD CMOS sensor,		
Video System	USB3.0	1080@60/50/30/25, 720@60/50/30/25, 1024x576@30	
	USB2.0	1280x720@25, 1024x576@30, 960x540@30, 640x360@30, 352x288@30	
Lens Zoom	5x optical zoom, 2x digital zoom		
Focal length	f=3.1~15.5mm, F1.8~F2.8		
View Angle	85° (wide)~ 20° (Tele)		
Vertical viewing angle	52.4° ~ 11.7°		
Diagonal viewing angle	90.9° ~ 22.5°		
Minimum Object Distance	Wide: 0.3m; Tele: 1m		
SNR	>50dB		
Image parameter			
Noise Reduction	2D/3D		
Minimum LUX	0.7lux (50 IRE Max AGC, 1/30, F1.8)		
White Balance	Auto/Manual/Indoor/Outdoor/Push/Sodium/Fluorescent		
Focus	Auto / Manual		
Iris	Auto / Manual		
Electronic Shutter	Auto / Manual		
BLC	Supported		
Mechanism			
Pan Rotation Angle	-170° ~ +170°		
Tilt Rotation Angle	-30° ~ +90°		
Pan Rotation Speed	0°~120°/s		
Titl Rotation Speed	0°~80°/s		
Preset	128 presets via RS232, 10 presets via remote controller		
Control	RS232/RS485/USB/Remote Controller		
Video Port:	USB3.0		
General			
Input voltage	DC12V		
Operating Temperature	-10°C~ 50°C		
Operating Humidity	≤80%		
Color	Silver		
Camera Dimension	148mm×132mm×161mm		
Package Dimension	28x24x24cm		
Package Content	Camera, Remote Controller, RS232 cable, USB3.0 cable, Power Supply		



Back of Meet 5



### Telecam Technology Co.,Ltd

6 Floor, Building A, Shuanghuan Information Technology Industrial Park, No.8,  
Baoqing Rd, Longgang District, Shenzhen, 518116, China  
Tel: +86-755-33275155    <https://www.telycam.com>